

DownEaster

WWW.DOWNEASTERMFG.COM



IP DUMP INSERT SERIES

Models:

IP100

IP110

IP100S

IP110S



CAUTION

Do not overload vehicle beyond the vehicle's Gross Vehicle Weight Rating (GVWR) or Gross Axle Weight Ratings (GAWR). Check the vehicle's load rating certification sticker for maximum vehicle capacity.

DUMP INSERT CAPACITY = 6000 POUNDS

Owner's Information:

Owner's Name : _____ Dealer : _____

Purchase Date : ____ / ____ / ____ Phone : (____) ____ - ____

Part # : _____ Serial # _____ Weight # empty: _____

Other _____ Weight # loaded: _____

OWNER'S MANUAL 2015

Contact your local dealer or distributor for replacement parts and technical support or visit

www.downeastermfg.com

CONTENTS

Contents	Page	Page
Introduction	2	Material Chart 13
Safety	3	Parts Guide 14
Warnings	4	Trouble shooting 15
Mounting	5 thru 10	Back Page / Warranty 16
Tarp Install	11, 12	

Introduction

Thank you for purchasing a DownEaster Dump Insert. This Owners Manual provides easy to follow instructions for installing, operating, and servicing the unit. Read the entire manual carefully to learn the proper procedures for each operation. Follow all of the instructions described to keep the dumper in top condition and it will provide years of trouble-free performance. In the event that a problem should arise or if you have any questions about the spreader please contact your DownEaster dealer.

All information, illustrations, and specifications in this manual are based on the latest DownEaster Dump Insert and Trailer information available at the time of publication. The manufacturer reserves the right to make changes and improvements without notice.

***** NOTE: Read this manual and fully understand the information presented before starting or operating the equipment.**

***** NOTE: Some short bed Dodge ram trucks from 2003 to 2009, may require an extension kit, due to the bed length of 6'-4", being 2" short of nominal length for proper clearance.**

SAFETY



THIS SIGN SHOULD ALERT YOU:

The Society of Automotive Engineers has adopted this SAFETY ALERT SYMBOL to pinpoint characteristics that, if NOT carefully followed, can create a safety hazard. When you see this symbol in this manual or on the the machine itself, BE ALERT! Your personal safety and the safety of others is involved.

The purpose of safety symbols is to draw attention to possible dangers. The safety symbols and explanations with them deserve your careful attention. The safety warnings do not by themselves eliminate any danger. The instructions or warnings they give are not substitutes for proper accident prevention procedures.



DANGER

Identifies the most serious hazards



WARNING

Failure to obey a safety warning can result in injury to yourself and others



CAUTION

Indicate[s] a hazardous situation which, if not avoided, could result in minor or moderate injury.

* NOTE - Advises of general information or instructions important to the operation or maintenance

SAFETY

Carefully read this manual. Learn how to safely operate the DownEaster Spreader and how to use the controls properly. Do not allow anyone to operate the DownEaster spreader without proper training and instruction. Unauthorized modification to the DownEaster Spreader may impair the function and/or safety of the machine.

Follow safety instructions

Read all safety messages in the manual and on the DownEaster spreader safety labels. Follow recommended precautions and safe operating practice. Maintain all safety labels on the DownEaster spreader in good condition. Replace missing or damaged safety labels, with new labels, available through your DownEaster dealer.

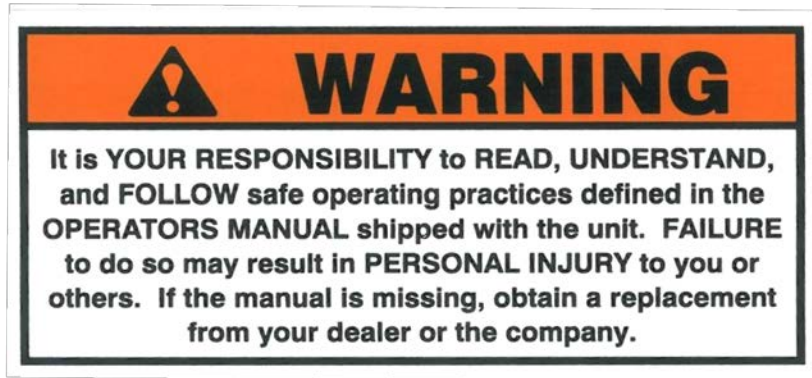

Pre Operation

Thoroughly inspect the DownEaster Spreader, for loose or damaged parts, before each use. Do not use until adjustments or repairs are made.

Keep all bystanders, especially children and pets, well away from the area, where the machine will be operated.

Keep all bystanders, a minimum or 20 feet away when unit is operational.



WARNINGS



Before attempting any procedure in this book, these safety instructions must be read and understood by all workers who have any part in the preparation or use of this equipment.



For your safety, warning and information decals have been placed on this product to remind the operator of safety precautions. If anything happens to mark or destroy the decals, please request new ones from DownEaster.



Unit must be pinned and locked into position before operating.



Never exceed the Gross Vehicle Weight Rating of vehicle. Failure to do so may limit handling characteristics.



Always inspect unit for defects: broken, worn, or bent parts, weakened areas or mounting.



Always shut power source before attempting to service unit. Be sure vehicle wheels are properly braked or chocked.



Always keep hands, feet, and clothing away from power-driven parts. Remember it is the owner's responsibility to communicate information on safe usage and proper maintenance of all equipment.



Always make sure personnel are clear of areas of danger when using equipment. Maintain 20' distance from all bystanders when operating the dumper.



Inspect the unit periodically for defects. Parts that are broken, missing, or worn out must be replaced immediately. The unit, or any part of it can not be altered without prior written permission from the manufacturer.



Never leave material in tub body for long periods of time. Be aware that some materials are hygroscopic and will attract atmospheric moisture and harden up.



Remember, most accidents are preventable and caused by human error. Exercising of care and precautions must be observed to prevent the possibility of injury to operator or others!



Never operate equipment when under the influence of alcohol, drugs, or medication that might alter your judgment and /or reaction time.



Before working with the unit, secure all loose clothing and unrestrained hair.



Always wear safety glasses with side shields when servicing spreader. Failure to do this could result in serious injury to the eyes.

INSTALLATION

Parts List

Each DownEaster Dump Insert includes the frame, dump bed, hoist and controls, battery cables and hardware kit. The hardware kit includes 4 clamps, 4 carriage bolts, 8 flat washers, 4 lock washers, and 4 nuts.



NOTE: some short bed Dodge ram trucks from 2003 to 2009, may require an extension kit, due to the bed length of 6'-4", being 2" short of nominal length for proper clearance.

Installation

- 1 Remove tailgate from truck. If the truck has a removable bed liner or mat, it **MUST be removed**.
- 2 Check the hydraulic fluid reservoir. With the dumper in the down position, the fluid in the reservoir should be within 1 to 1½" of the top of the tank. If necessary, fill with automatic transmission fluid before operating.
- 3 Most Ford pickups have bolts in the bed that extend through the cross members or frame. Use the existing bolt holes to mount the frame of the dump insert.
- 4 On most other trucks, you will need to drill, four 9/16" diameter holes, to mount the insert.

The two holes at the front of the truck should go through the cross member closest to the front of the truck. These holes should be approximately 17" to the right and left of the center of the truck bed. The two holes at the rear of the truck should go through the center of the top frame rail, approximately 5" in from the rear of the truck bed. **(SEE FIG. 1-A FOR CUT AWAY VIEW)**

Use minimum of ½" bolts with lock washers and shake proof nuts.

continue on next page

INSTALLATION

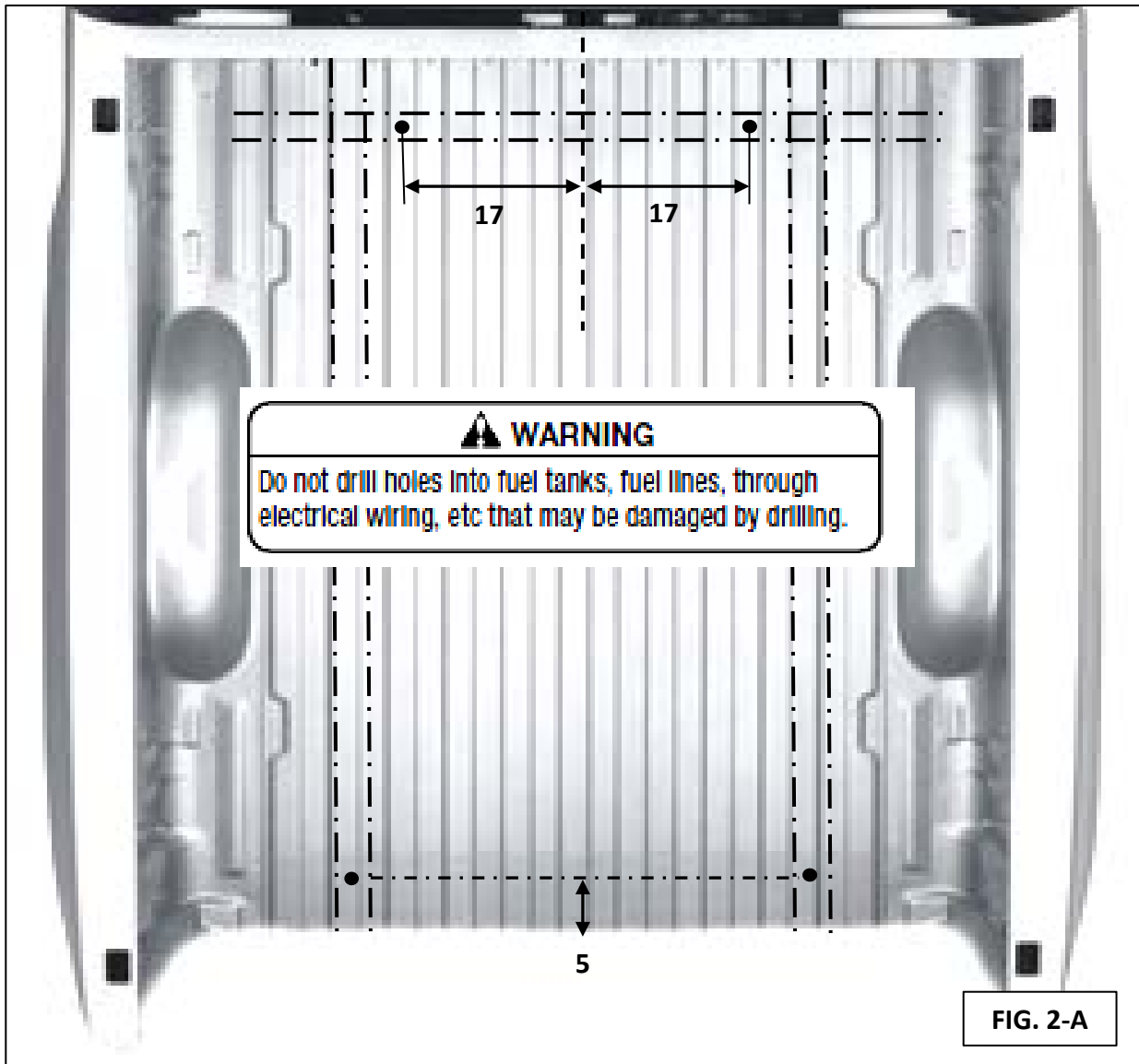
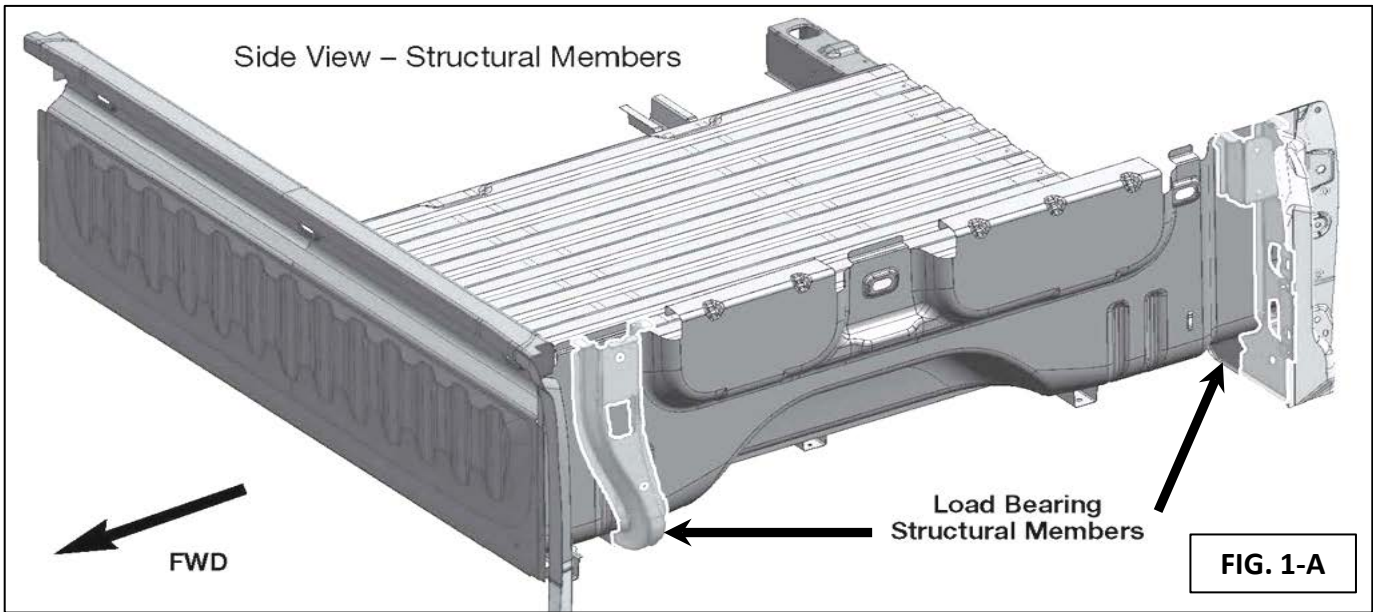

INSTALLATION

NOTE: DO NOT MOUNT TO PLASTIC REMOVABLE BED LINERS

DO NOT MOUNT TO BED SHEET; UNIT MUST BE BOLTED TO TRUCK FRAME OR CROSS MEMBER!

- 5 Set the insert into the truck bed, leaving about 18" clearance at the front of the truck bed.
- 6 Remove the two shipping straps from the front of the dumper. The straps connect the dump bed to the frame to protect the unit during shipping.

To insure good performance of your spreader, check the condition of truck's electrical system. Using a digital voltmeter, check alternator and battery voltage. The voltage reading should fall between 13.6 and 15.3 volts with engine running, head lights and heater fan turned on. If voltage reading falls out of this range check and adjust your electric system.

Thoroughly clean battery terminals. Make sure battery terminals have no tarnish or corrosion. DO NOT CONNECT WIRE HARNESS TO DAMAGED OR CORRODED TERMINALS! IT MAY RESULT IN



CAUTION

ALWAYS DISCONNECT BATTERY BEFORE ATTEMPTING TO INSTALL ELECTRICAL COMPONENTS ON YOUR VEHICLE.

▲ CAUTION

Batteries normally produce explosive gases which can cause personal injury. Therefore, do not allow flames, sparks or lit tobacco to come near the battery. When charging or working near a battery, always cover your face and protect your eyes, and also provide ventilation.

- Batteries contain sulfuric acid which burns skin, eyes and clothing.
- Disconnect the battery before removing or replacing any electrical components.

- 7 Lay out all the 6 Gauge cables to their respective routes, in the engine compartment, making sure the short cables can reach the battery terminals, from the circuit breaker mounting location.

Chose clean, dry and cool areas, away from the exhaust, for the 120 Amp circuit breaker and relay. Mount with the self tapping screws supplied in the install kit, unless other means of mounting with bolt style fasteners is more suitable.

- 8 Lay out all the 6 Gauge cables, to the dumper end, to their respective routes, in the engine compartment and along side the vehicle frame. Run the cables back from the vehicle battery, under the cab, and up between the cab and truck bed.



CAUTION

DO NOT CONNECT BATTERY CABLES AT THIS POINT.

- 9 We recommend wrapping the cable in wire loom, to protect it, from damage. Keep the cable clear of the exhaust system and protect at points of rubbing and sharp edges. Do not expose the cable below the frame and prevent it from drooping.

continue on next page

INSTALLATION

- 10 The control box for the insert can be located inside the cab, or left in the truck bed. If you want to leave the control box in the truck bed, skip to the next step.
- 11 To locate the control box in the cab, remove the three wire terminals from the pump. If necessary, drill a hole in the cab, run the wires back to the pump, and reconnect them as shown in Fig. 3-A (Your unit may have a quick connect plug in, if so reconnect plug)

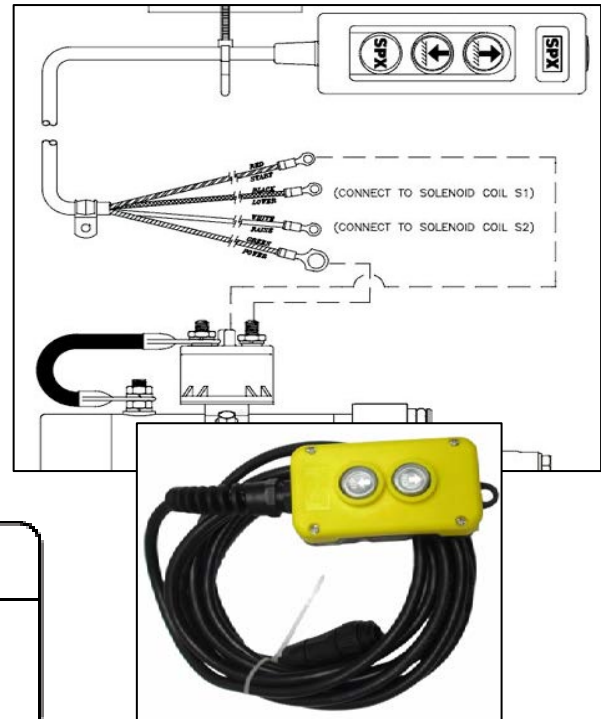
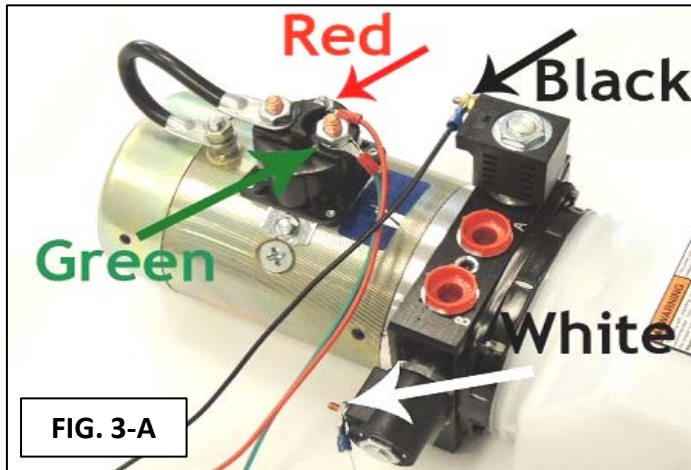

WARNING

Do not install control box in the vehicle's airbag deployment area. Refer to the vehicle's manual for airbag deployment area.

- 12 Connect the battery cables to the hydraulic pump. Connect the negative terminal to the bolt on the insert frame directly behind the pump. Connect the positive terminal to the bolt on top of the solenoid closer to the hydraulic fluid reservoir (on top of the green wire to the control box in Figure 3-A).
- 13 Slide dumper completely into truck bed, checking for proper clearance. Center the unit in the truck bed. The rear cross member of dumper frame must not extend beyond truck bed. Allow ½" minimum clearance between dumper and front wall of the truck bed.

NOTE: some short bed Dodge ram trucks from 2003 to 2009, may require an extension kit, due to the bed length of 6'-4", being 2" short of nominal length for proper clearance.

Connect battery cables to positive and negative terminal of battery then raise the unit.



CAUTION

DO NOT BLOCK BODY UNDER LOADED CONDITIONS

- 14 Block the unit in raised position, for installation and servicing, to prevent accidental lowering. A prop is provided for blocking.

continue on next page

INSTALLATION

- 15 Four clamps are provided for easy installation of your insert. Set the clamps over the frame so that the slots on the clamps fit over the holes prepared in step 3. The clamps at the rear of the truck bed will fit over the cross member on the dump insert frame that extends from either side of the frame. The front clamps will be positioned over the frame's side members. Fasten the clamps with the hardware provided as shown in Figure 4-A. Important: Check the bolts after driving the vehicle 100 miles and periodically thereafter to ensure they remain tight.

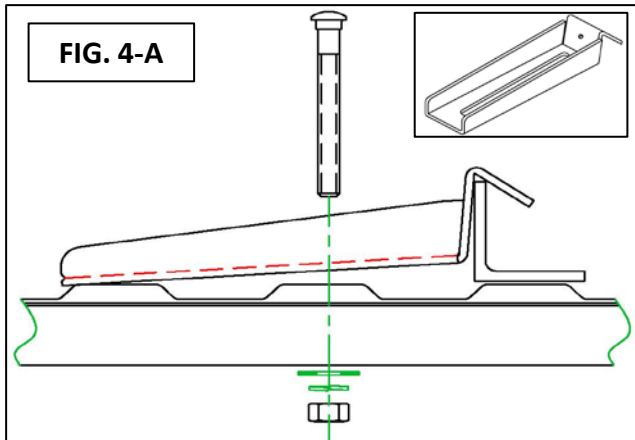

Size	Torque		
	SAE Grade 2	SAE Grade 5	SAE Grade 8
1/4-20	6 (8)	9 (12)	13 (18)
5/16-18	11 (15)	18 (24)	28 (38)
3/8-16	19 (26)	31 (42)	46 (62)
3/8-24	24 (33)	46 (62)	68 (92)
7/16-14	30 (41)	50 (68)	75 (102)
1/2-13	45 (61)	75 (102)	115 (156)
9/16-12	66 (89)	110 (149)	165 (224)
5/8-11	93 (126)	150 (203)	225 (305)
3/4-10	150 (203)	250 (339)	370 (502)
7/8-9	150 (203)	378 (512)	591 (801)
1-8	220 (298)	583 (790)	893 (1211)

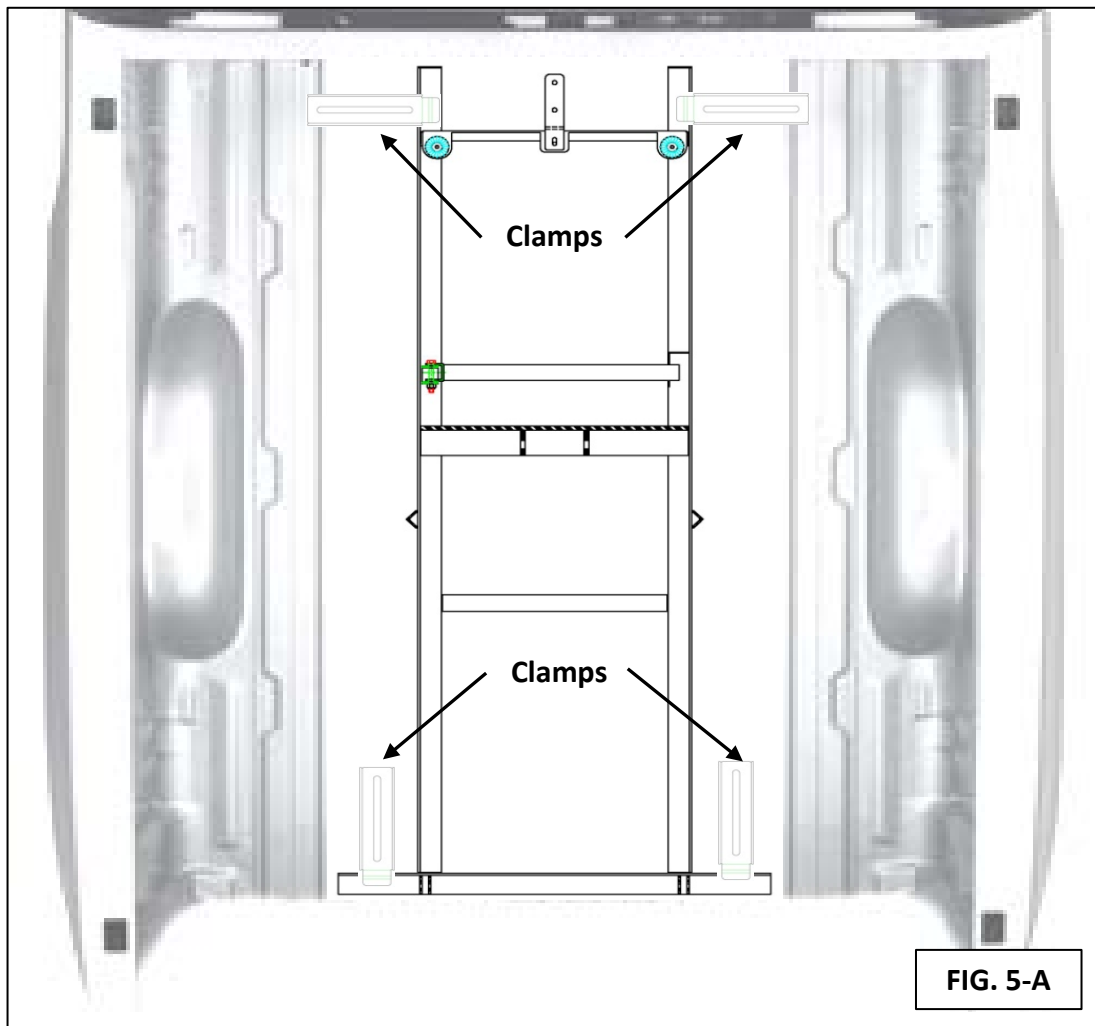

INSTALLATION

- 16 Remove the prop blocking the unit. Use the remote control to cycle the unit several times. If the dumper is too close to the front wall of the truck bed it will not work freely. If the solenoid flutters or if the unit rises very slowly, there is probably a bad ground or a loose connection.

Ensure proper operation of dump components and/or body, if equipped, to clear all hoses, wiring harnesses, and other obstructions.

- 17 Cycle several times. Press the "Up" arrow on the hand control to raise dump bed. Press the "Down" arrow on the hand control to lower the dump bed. Recheck all bolts to make sure unit is secure. Raise unit and block up using prop rod.

- Unplug Remote cord and hand control from the pump.
- Mount hand control in cab of truck, following instructions on page --- of the instruction manual.
- Remote control box must be mounted in cab of truck. Unit is **not** waterproof and extended exposure to moisture will cause damage to control

Your DownEaster Dump Insert is ready to provide you with years of reliable use. Maintain the unit by checking the bolts periodically to ensure they are tight. Grease the fittings at all the pivot points regularly; at least as often as you grease your truck, or more if the insert is used frequently or under harsh conditions.

Do not exceed 5 MPH with the Dump Insert in the upright position. Avoid sudden stops with unit in upright position.

Lubrication

1. Use Cold Weather Multipurpose Grease to lubricate grease fittings at the scissor hoist. Lubricate grease fittings after each increment of ---- hours of use, monthly or according to the maintenance schedule.

Pendant Cord

! WARNING Keep the electrical wires away from hot exhaust parts and any moving drive components.

Optional Cab Shield

Mount the cab shield, at the front of the insert, and use supplied hardware kit to fasten. 3 - 5/16" bolts, washers, lock washers and hex nuts for the front holes. 4 - 1/4" bolts, washers, lock washers and hex nuts for the outer side mounting. Tighten to torque specs once set in place.

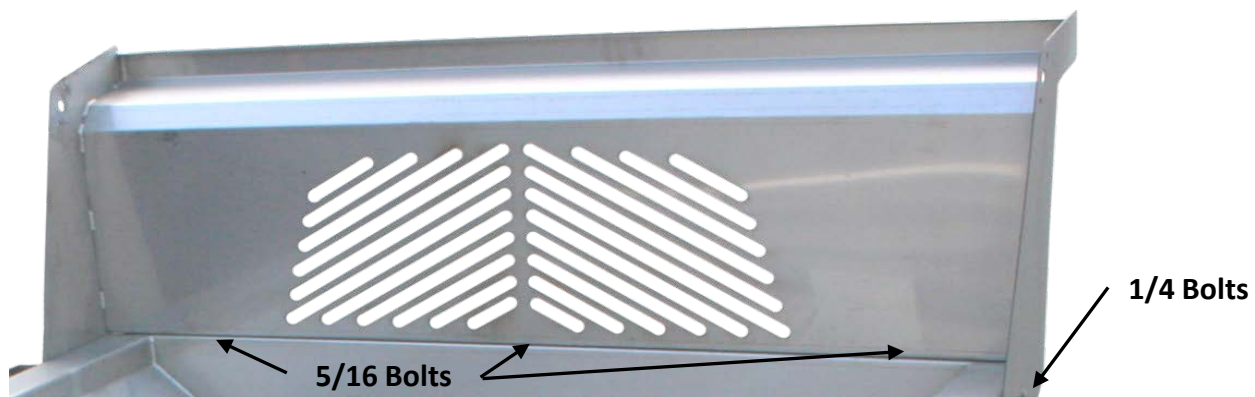

MATERIAL CHART

AGGREGATE TYPE	WEIGHT IN LBS.	2 YARDS	3 YARDS	4 YARDS	5 YARDS
Asphalt	2,700	5400	8100	10800	13500
Concrete (gravel or stone mix)	4,050	8100	12150	16200	20250
Concrete (average wet mix)	3,730	7460	11190	14920	18650
Clay (dry)	2,300	4600	6900	9200	11500
Clay (wet)	2,970	5940	8910	11880	14850
Crushed Stone	2,700	5400	8100	10800	13500
Topsoil (loose)	2,050	4100	6150	8200	10250
Topsoil (packed)	2,565	5130	7695	10260	12825
Topsoil (wet)	3,375	6750	10125	13500	16875
Gravel (dry) 3/4	2,565	5130	7695	10260	12825
Gravel (wet) 3/4	3,375	6750	10125	13500	16875
Limestone (solid)	4,480	8960	13440	17920	22400
Limestone (crushed)	2,565	5130	7695	10260	12825
Pebbles (3/8 pea)	2,700	5400	8100	10800	13500
Rock (2-6")	3,200	6400	9600	12800	16000
Rip Rap (1-4")	4,000	8000	12000	16000	20000
Sand (dry)	2,750	5500	8250	11000	13750
Sand (wet)	3,300	6600	9900	13200	16500
Salt (bulk)	2,160	4320	6480	8640	10800
Salt/Sand Mix	2,320	4640	6960	9280	11600
Snow (packed)	1,350	2700	4050	5400	6750
Stone (crushed - average)	2,700	5400	8100	10800	13500
Water	1,700	3400	5100	6800	8500

All posted weights were gathered from the EPA & NTEA.

TARP INSTALLATION

DownEaster

ITEM LIST

Part Number	Part
11661	Fold-away Crank Handle for Cab Level
11201	Spool Shaft 5" Length
11139	3/4" Axle Bearing, 2 pcs
12382	Plastic Tarp Axle Cap, 2 pcs
13467	Aluminum Rear Pull Bar - 103" Length
14666	Tarp Axle Extension, 24" Length
14861	Tarp Axle, 51" Length
14860	Tarp Axle, 31" Length
14988	Pull Rope, 25 feet
15263	Welded Ring, 2 pcs
12282	J-Hooks, 4 pcs
13771	Plastic Pull Bar Handles, 2 pcs



Tools required: 2 - 1/2" wrenches

Drill w/ 5/16" nut driver socket

Hack saw (or equivalent)

5/8" wrench

Tape measure

Marker

Small half round file

STEP #1 - MOUNTING THE TARP AXLE

1) Insert the 31" Tarp Axle, with the Crank Handle, into the mounting hole on the Driver's side. Loosely mount the Axle Bearing with the supplied hardware. Bearing will be on the outside of the bracket.



2) Depending on the width of the trailer / dump body being mounted to, the passenger side 51" tarp axle may have to be cut to length. A standard hacksaw or other cutting tool will be sufficient. Carefully, deburr any sharp edges from the aluminum axle tube.

Tarp Axle Cut Guide:

IP series truck insert = 12 1/2"

TR508 dump = 21"

TQ610/12 dump = 9"

TR6-8X12/14 dump = 0"

88" wide dump body = 2"

96" wide dump body = 0"

*Thread 5/16" bolts into the square nuts, lock side out. Slide all 5 into the axle channel **BEFORE** next step.*

3) Insert the Tarp Axle, without the Crank Handle, into the mounting hole on the Passenger's side and mate it with the Tarp Axle on the Driver's side. Loosely, mount the Axle Bearing with the supplied hardware.



4) Fully tighten the hardware for both Axle Bearings, verifying that the tarp axle rotates freely.



TARP INSTALLATION

STEP # 2 - INSTALLING THE TARP

Unfold the Tarp and mount the front of the Tarp, to the Tarp Axle, centered in the trailer tub, through the 5 grommets; securing the grommets to the square bolts, using the supplied 5/ 16" bolts with washers. Hand tighten until all 5 are in place. Tighten accordingly.

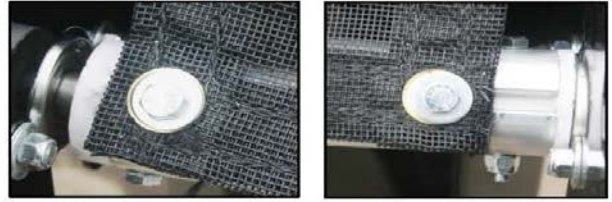

STEP # 3 - INSTALLING THE REAR PULL BAR

1) The Rear Pull Bar, depending on model of trailer, truck, or dump insert, may have to be cut to length. Approximately 4" should be protruding from each side of the end of the tarp splint. The end of the tarp has a round cord, which slides into the extrusion of the pull bar.



2) Slide the Rear Pull Bar onto the Splint: on the rear of the tarp.

3) Slide a Plastic Pull Bar Handles onto each end and secure with the 2" Fender Washer and the M 10 Bolts



STEP # 4 - INSTALLING PULL ROPE

1) Attach the free end of the Pull Rope to the center of the Rear Pull Bar, through the grommet, with cut end facing upwards. Cut rope to desired length, and tie a knot.



2) Mount two *J-hooks*, with the supplied self-tapping bolts, opposing each other near the rear of the dump, (typically on the gate) to secure the Pull Rope in the covered position.

3) Mount two *I-hooks* with the supplied self-tapping bolts opposing each other near the front of the dump to secure the Pull Rope in the uncovered position.



REPLACEMENT PARTS

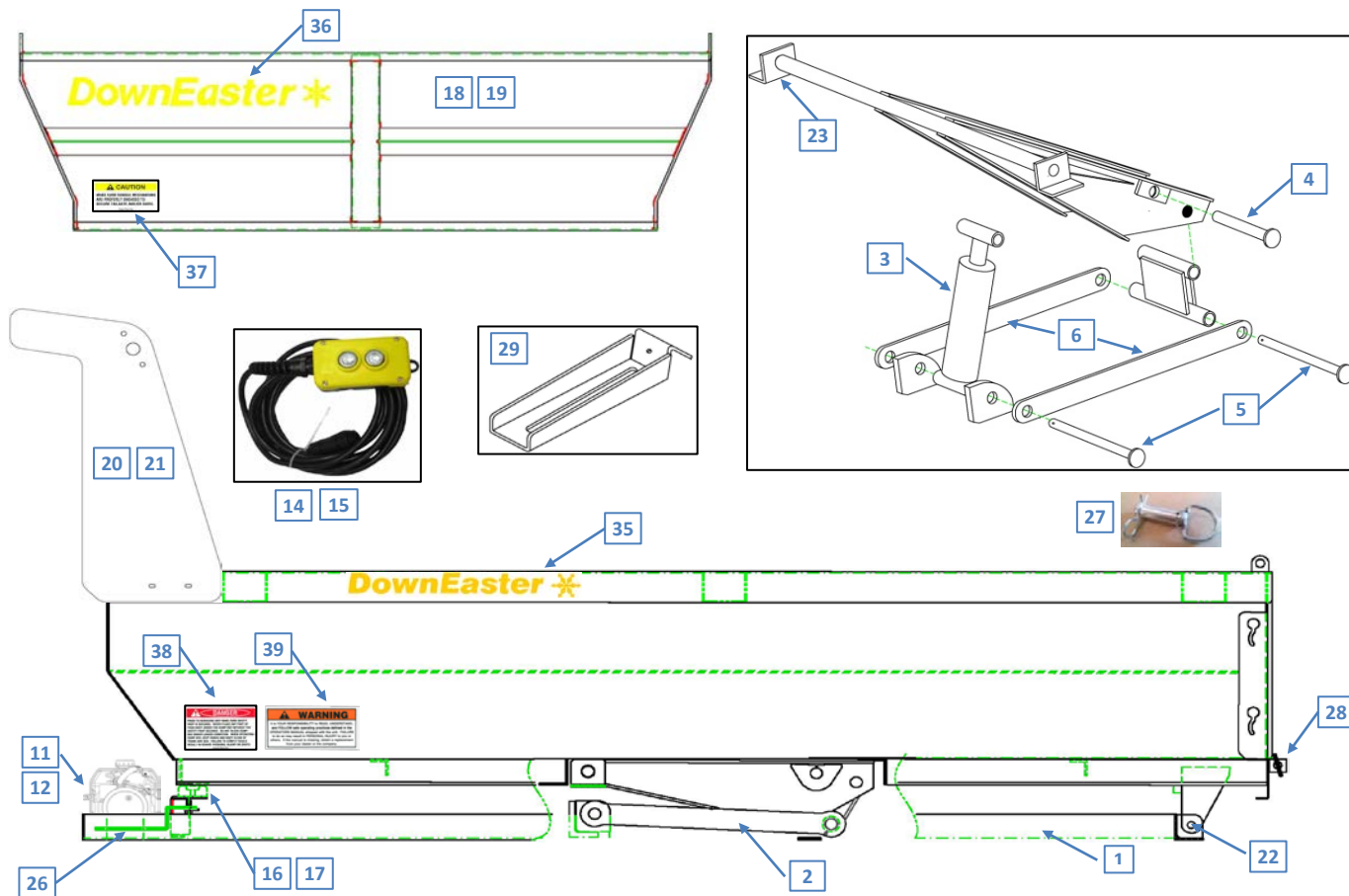

KEY	PART #	DESCRIPTION
1	TA170 / 171	Lower frame assembly 8' / 6.5' (no hoist)
2	TA172	Scissor hoist frame assembly (no cylinder)
3	TPH138	Hydraulic cylinder
4	HWF100	Bolt 1' x 8"
5	HWF105	Bolt 1' x 9 1/2"
6	TA272	Scissor arm, sold in pairs
7	TPH195	Hydraulic hose (single stage) 8'
8	TPH196	Hydraulic hose (dual stage) 8'
9	TPH193	Hydraulic hose (single stage) 6.5'
10	TPH194	Hydraulic hose (dual stage) 6.5'
11	TPH107	Hydraulic pump (single stage)
12	TPH108	Hydraulic pump (dual stage)
13	.704	Seal rebuild kit, cylinder
14	TPE153	Pendant control (single stage, 3 wire)
15	TPE169	Pendant control (dual stage, 4 wire)
16	TPL121	Bump stop
17	HWF850	Washer, shim

KEY	PART #	DESCRIPTION
18	TA176	Tailgate, Painted black
19	TA177	Tailgate, Stainless steel
20	IP120	Cab shield, Painted black
21	IP120S	Cab shield, Stainless steel
22	HWF615	Hinge bolt, shoulder, Allen head (w/ nut)
23	N/A	Upper lift rod assembly, weld in only,
24	TA173	Prop rod, bolt on
24	TKA151	Tailgate chain, (pair)
26	IP210	Pump mounting bracket, painted black
27	TA188	Pin, upper, 3/4" w/ ring.
28	TPM119	Pin, spring retractable, weld on
29	IP510	Bolt down, (x1)
30	HWF607	Bolt down hardware kit
31	TKA105	Install kit, complete w/ harness cables, breaker, bolt downs
32	IP600	Dodge short bed mounting kit 2003-2009
33	TARP6312	Tarp kit, complete
34	TPU106	Tarp mesh, replacement

KEY	PART #	DESCRIPTION
LABELS	35	LBL102 Label Thermal die cut Downeaster
	36	LBL104 Label Thermal die cut Downeaster
	37	LBL110 Label Caution make sure handle mechanisms.....
	38	LBL112 Label Danger prior to servicing make sure safety prop is...
	39	LBL127 Label Warning it is your responsibility to read,understand

TROUBLE SHOOTING

If malfunction of the power unit should occur, inspect all hydraulic lines and electrical connections, and check for a good ground. Many malfunctions are caused by loose connections. Check the reservoir for proper fluid level (approximately 1/2" from top of tank when dumper is down). If fluid must be added, use clean Dextron III. Please keep in mind when servicing this unit that the most common cause of system failure is dirt!!! Keep service area clean.

In most cases a leaking relief valve is caused by dirt. Unscrewing relief valve and cleaning thoroughly can often correct this.

1. If unit does not operate at all: Malfunction is due to switch, solenoid, motor, dead battery, corroded terminals, or bad connections at the pump motor package.
2. If unit operates slowly and/or with low pressure: Malfunction is due to a leaking relief valve, clogged filter, worn pump, corroded or bad battery terminals, or hydraulic fluid that is too heavy.
3. If unit is unable to hold pressure: Malfunction is due to a leaking relief valve.

Unit does not lift but pump runs.

1. Fluid low
2. System is hydra locked and needs be bled.
3. Pump pressure is set too low.

Pump motor does not run.

1. Motor solenoid is bad.
2. Connections from the battery are loose or dirty.
3. Ground connection is loose or not grounded properly.
4. Battery needs to be charged.

Unit does not go down.

1. Down coil is bad and needs replaced.
2. Down valve cartridge needs to be replaced.
3. Connection to the down coil is bad.

General Provisions: Coastal Metal Fab, Inc. warrants its products to be free from manufacturing defects under normal use and service conditions and will repair or replace, at its option, any products or components thereof that are proven to be defective during the warranty period as specified below. This warranty extends to the original retail purchaser only and commences on the date of original purchase. Coastal Metal Fab's maximum liability under this warranty is limited to the cost of the repair or replacement of any defective products or components, and excludes any incidental or consequential damages. The warranty period is as follows:

DownEaster brand Dump Trailers and Dump Inserts -- 2 years from date of purchase

DownEaster brand Salt and Sand spreaders -- 1 year from date of purchase

DownEaster brand Dump Bodies -- 2 year from date of purchase or 24,000 miles

Items Warranted Separately: This warranty does not apply to certain components that are warranted separately by the original equipment manufacturers including, but not limited to, electric or gasoline motors, hydraulic pumps, hydraulic cylinders, tires, wheels, and axles.

Items not Covered: Coastal Metal Fab, Inc. is not responsible for the following:

- Premiums charged for overtime labor requested by the purchaser.
- Transportation to and from the dealership or service calls made by the dealer.
- Products purchased used.
- Products that have been altered or modified in ways not approved by Coastal Metal Fab.
- Depreciation or damage caused by normal wear and tear, lack of reasonable and proper maintenance, failure to follow operating or installation instructions, misuse, lack of proper protection during storage or accidents.
- Normal maintenance costs.

Parts Replaced under Warranty: If Coastal Metal Fab, Inc. elects to repair a defective product or component thereof, Coastal metal Fab will, at its discretion, utilize either new or remanufactured parts or components. If any such part or component proves to be defective within 12 months of installation or before expiration of this warranty, whichever is later, Coastal Metal Fab, Inc. will repair or replace, as it elects, such defective part or component.

Securing Warranty Services: To obtain service under this warranty, the original retail purchaser must request warranty service during the applicable period of warranty from a dealer authorized to sell the product being serviced. When making such a request, the purchaser must present evidence of the product's original purchase date, and make the product available for service at the dealer's place of business.

Limitations: The selling dealer has no authority to make any representation or promise on behalf of Coastal Metal Fab or to modify the terms or limitations of this warranty in any way. Coastal Metal Fab shall have sole discretion to determine whether a product or component is defective. Coastal Metal Fab reserves the right to discontinue or modify any of its products and, if Coastal Metal Fab elects to replace a defective product under this warranty which has been discontinued or modified, it may do so with a product deemed by Coastal Metal Fab to be of comparable quality and function.

THIS WARRANTY IS GRANTED IN LIEU OF ALL OTHER WARRANTIES WHETHER EXPRESS OR IMPLIED INCLUDING, WITHOUT LIMITATION, THE IMPLIED WARRANTIES OF MERCHANTABILITY AND FITNESS FOR A PARTICULAR PURPOSE. UNDER NO CIRCUMSTANCE SHALL COASTAL METAL FAB BE LIABLE FOR ANY CONSEQUENTIAL OR INCIDENTAL DAMAGES OF ANY NATURE RESULTING FROM ANY DEFECT IN THE PRODUCT OR ITS COMPONENT PARTS. SOME STATES DO NOT ALLOW LIMITATIONS ON OR EXCLUSION OF IMPLIED WARRANTIES OR INCIDENTAL AND CONSEQUENTIAL DAMAGES SO THE ABOVE EXCLUSIONS MAY NOT APPLY TO YOU.

Contact your local dealer or distributor for replacement parts and technical support or visit

www.downeastermfg.com